



Elektrotechnik Karl-Heinz Mauz GmbH

GM25-370-16250-57-12D8 (Artikel-Nr. 860513)

EKULIT

SPECIFICATIONS:

Item	Unit	Specification
Rated voltage	VDC	6.0
Gear Ratio		1/75
Rotation		CW&CCW
Motor Position		All position in horizontal
Temperature	°C	0~30
Humidity	%	30~95
• Performance of Motor		
No-load Speed	rpm	3.600±10%
No-load Current	mA	30 (max.)
Stall Current	mA	850 (max.)
Stall Torque	g.cm	80
• Performance of Gear motor		
Output Speed	rpm	60±10%
No-load Current	mA	50 (max.)
Stall Current	mA	850 (max.)
Stall Torque	kg.cm	4
Rated Torque	g.cm	1000
Rated Current	mA	230 (max.)
Noise	dB	50
• The Dimension		
The Outside Shaft Length	mm	12
Shaft End Play	mm	0.05-0.50
Screw Size		M3
Dia of Shaft	mm	Ø4*D3.5

Adresse: Felix-Wankel-Str. 35 • 73760 Ostfildern/Nellingen

Tel: +49-711/3414023

Fax: +49-711/3414024

E-mail: info@ekulit.de Web site: www.EKULIT.de

Elektrotechnik Karl-Heinz Mauz GmbH

GM25-370-16250-57-12D8 (Artikel-Nr. 860513)

EKULIT

DIMENSIONS :
(Unit: mm)

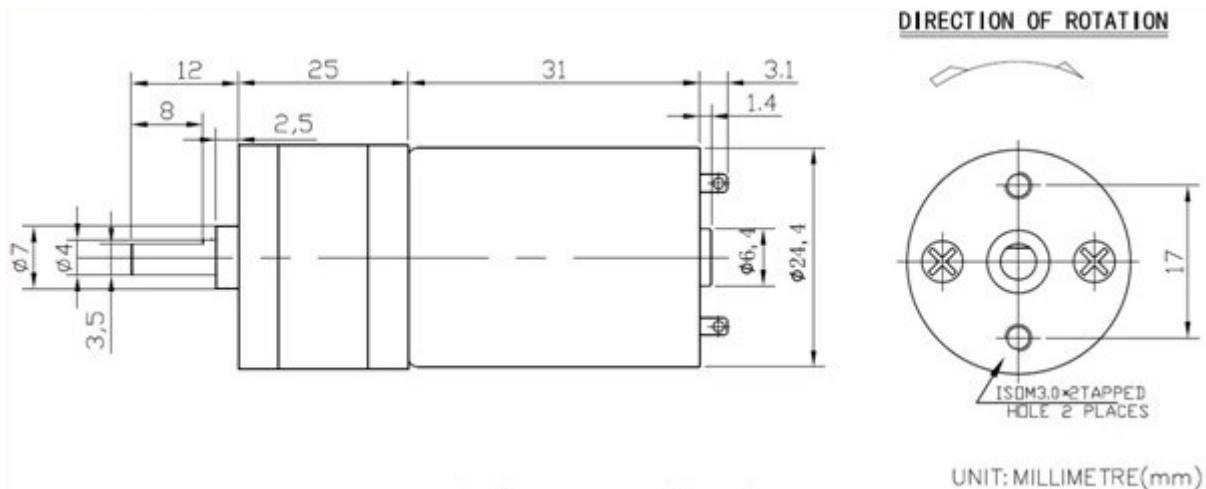

Curve drawings:

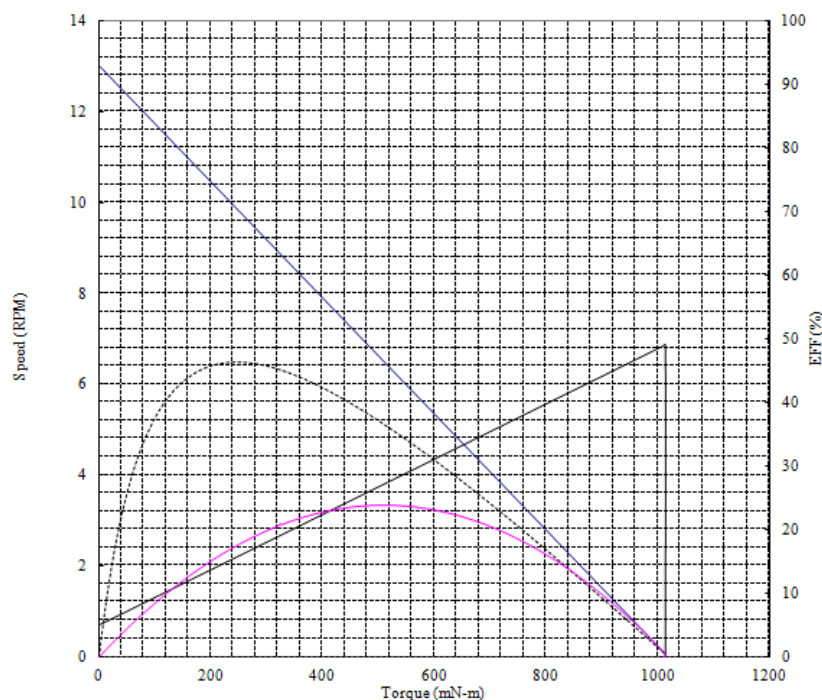

Adresse: Felix-Wankel-Str. 35 • 73760 Ostfildern/Nellingen

Tel: +49-711/3414023

Fax: +49-711/3414024

E-mail: info@ekulit.de Web site: www.EKULIT.de